

HANDS ON - HEARTS IN CAMPAIGN



HANDS ON - HEARTS IN CAMPAIGN **CASE STATEMENT**

With God's guidance and the support of the Unity constituency, the board is ready to embark on an exciting new campaign at Unity Christian High School.

The top two priority needs have been identified in the following areas:

1. More hands on educational spaces.
2. Enhanced food serving and dining areas.

The Board desires to further the mission of our school by increasing and renovating building spaces to:

1. Expand and grow our agriculture education.
2. Launch a new Industrial Arts program.
3. Upgrade our food preparation and dining spaces.

These programs will enhance our mission by **GUIDING** and **EQUIPPING** students with **ENGAGING** opportunities to learn and grow.

For this reason, we are calling it the **HANDS ON - HEARTS IN CAMPAIGN.**



MOVING FORWARD INTO A **NEW CAMPAIGN**

SHOP EXPANSION/NEW GREENHOUSE
\$4.1 MILLION

KITCHEN CAFETERIA
\$3 MILLION

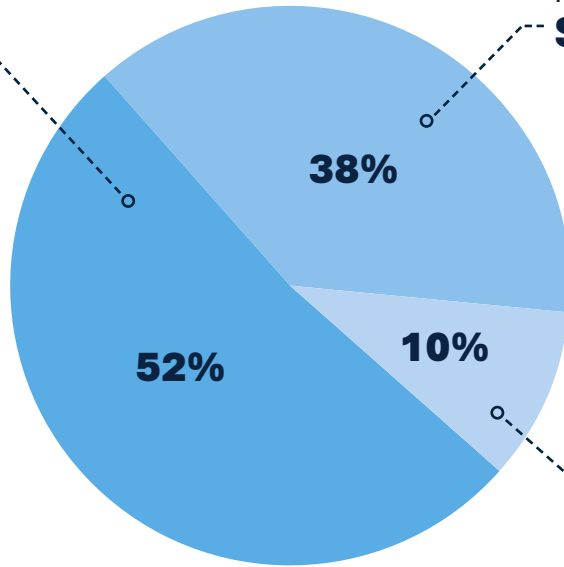

INTEREST &
EQUIPMENT
\$780,000

TOTAL PROJECT ANTICIPATED COST **\$7.8 MILLION**

PROJECT TIMELINE

LAUNCH DATE: Our goal is to launch this campaign in the Spring of 2026.

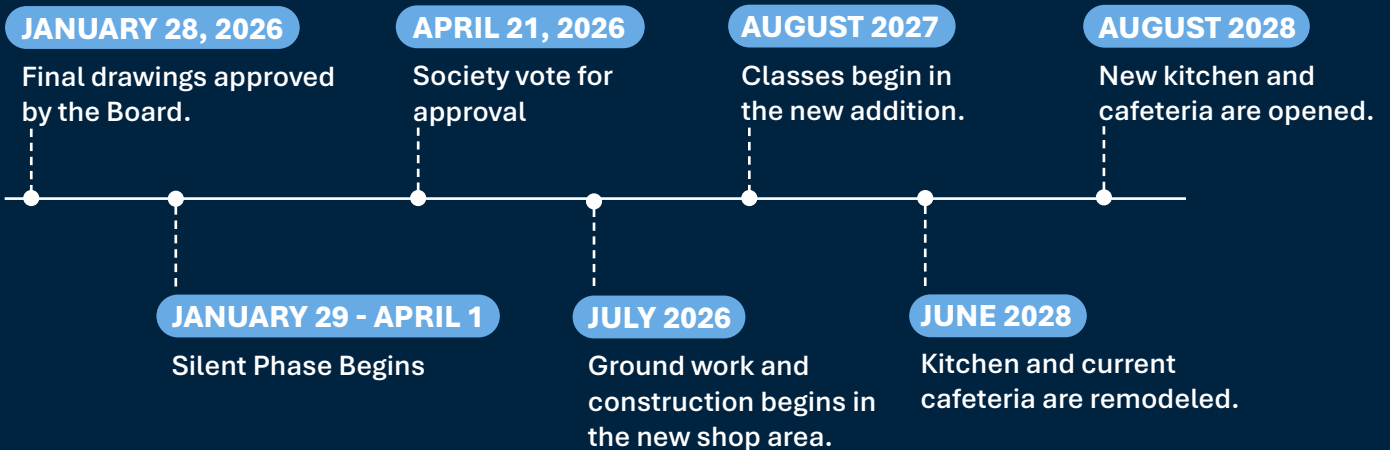

NEW CLASSROOM AND SHOP ADDITION

This 13,800 sq ft addition will accommodate the launch of a new Industrial Arts program for the school. It will also serve to support a growing ag program and allow for a new class with opportunities in life skills and foods.

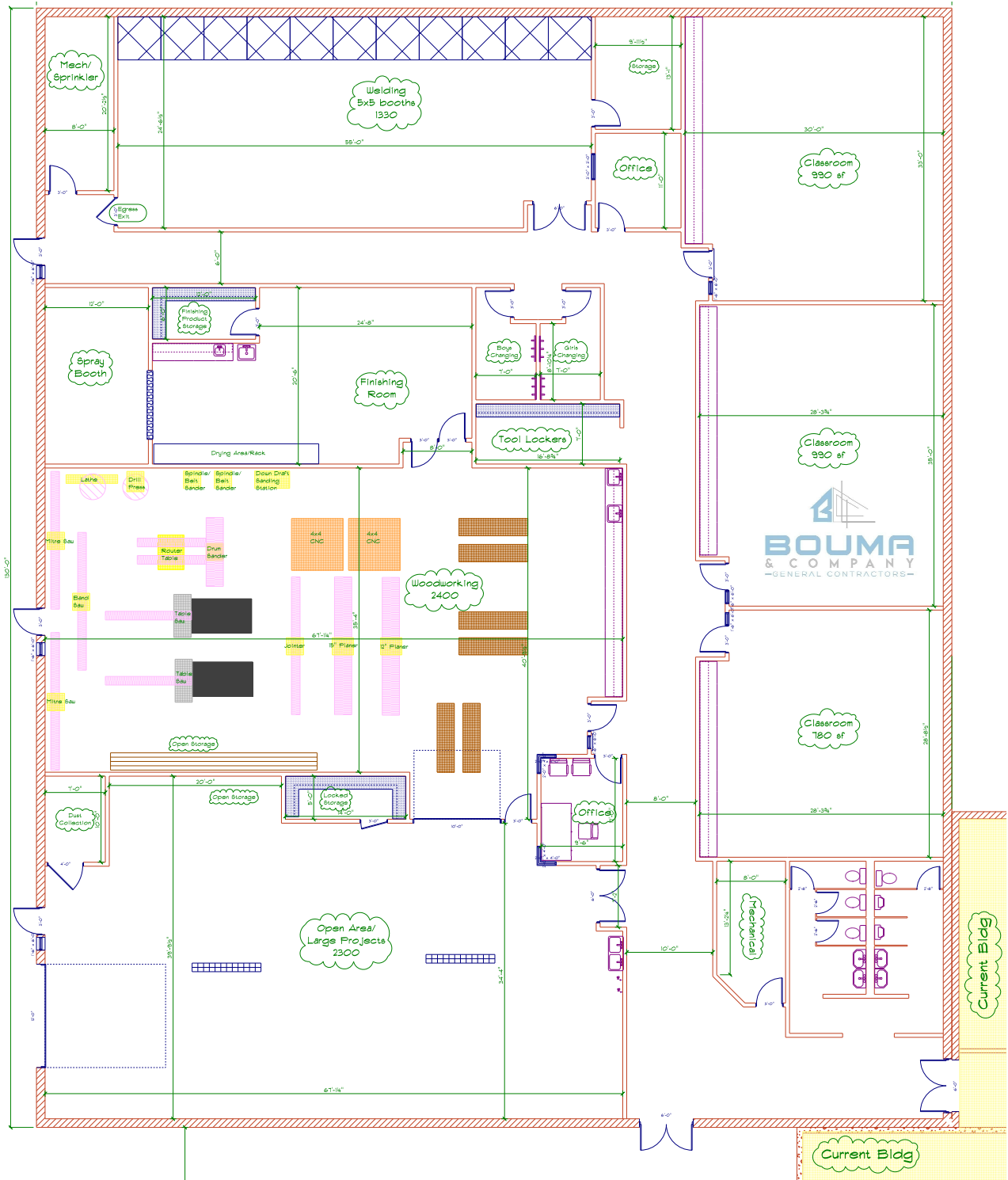

CLASSROOM & SHOP ADDITION **HIGHLIGHTS**

THREE NEW CLASSROOMS

accommodating ag classes, including a dedicated space to consider new program opportunities with food and life skills.

A LARGE OPEN SPACE

allowing for carpentry instruction and project builds, including high ceiling and high doors.

A WELDING SHOP

creating 11 stations, doubling our current stations.

A NEW & EXPANDED GREEN HOUSE

servicing both our ag and science departments, in addition to housing our aquaponics stations.



KITCHEN RENOVATION AND CAFETERIA EXPANSION

Enrollment growth has pushed our kitchen and cafeteria resources beyond our current production and eating capacity. A renovated kitchen and increased cafeteria space will enhance community, streamline food delivery, save on manpower and aid in leveraging a top tier lunch program.

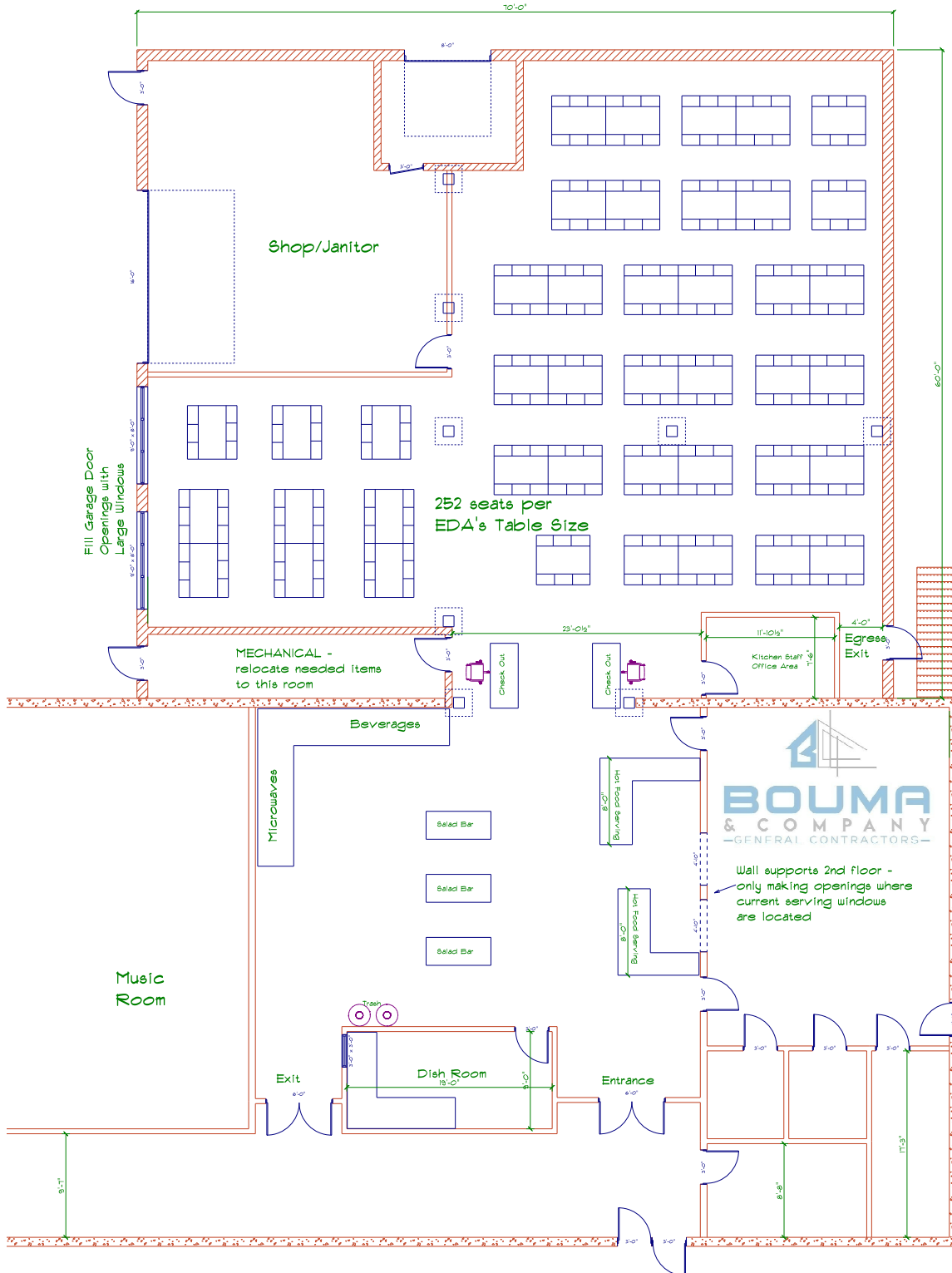

KITCHEN & CAFETERIA HIGHLIGHTS

RE-PURPOSING

space in the current shop and van garage areas to become a cafeteria that allows for seating of up to 250 individuals.

MOVING

the wash bay for dishes from inside the kitchen to a new area, giving more space in the kitchen for food prep.

CREATING

two food serving lines, thus speeding up food service.

EXPANSION

of the salad bar area and beverage serving stations.

DEDICATING

an office for our Food Services Director.



Please join us for a vote of support at the
April 21, 2026 Society Meeting.

No absentee ballots will be accepted for this project.

“

I am thrilled to see this proposal become a reality. Our students will receive **increased opportunities to discover passions and potential career pathways** in this new area.

- **JON HOLWERDA** *Principal*



“

This is a **great opportunity** for the students and the school. I'm looking forward to seeing **how far we can go.**

- **GRANT STELLING** *Instruction*



“

The delivery of food and the fellowship centered around eating food are critical to the overall mission of our school. **This project will elevate our culture significantly.**

- **WAYNE DYKSTRA** *Head of School*



OUR MISSION

Proclaiming that Jesus Christ is Lord of all, we provide a Biblically based education to guide and equip young people to serve both God and neighbor in all aspects of life.

INVITING. ENGAGING. TRANSFORMING.